



Flexlock Public 2.0 Card+

Mifare 13.56 MHz

Flexlock Public is a robust external antenna for use in public environments such as, schools, public spaces and hospitals. Used in combination with Flexlock Invisible Mifare 13.56 MHz. This lock is programmed with our Card+ system. Card+ has the same functions as Card, but this system offers, in addition to card or tag as a key, access to the locks via mobile phone and our Card+ app.

For use where the material or thickness means the signal from the lock alone is not enough, e.g. on metal doors or thicker doors made of wood. Possibility of being opened with an external power source. Always stays closed when the battery runs out. LED indicator that shows free storage.

Flexlock Card+ is a flexible locking system that allows locks to be locked and unlocked via our Card+ app alongside the standard card and key tag options. A convenient and user-friendly way to lock and unlock temporary storage solutions via your mobile phone. Open the Card+ app and then scan the QR code on the locker to gain access. The app is available for both iOS and Android. Immediately after download the app is ready for use and the user does not have to create an account or register.

The lock can be easily reprogrammed to add or remove users – or to change the lock function e.g. time-limited. Administration is carried out manually at each the lock and are programmed using programming cards.

Flexlock is a locking system that can be upgraded as your business grows. Your existing Invisible locks using Flexlock Card can be easily upgraded by replacing the antenna to enable Card+ or Smart.



- Installed both externally and inside of the unit
- Offers access to locks via card, key tag or mobile phone
- Easy to install, easy to use
- Robust and durable
- Easy to service and administer
- Battery powered
- Can be opened with an external power source
- Can be programmed with various functions

Technical Specifications

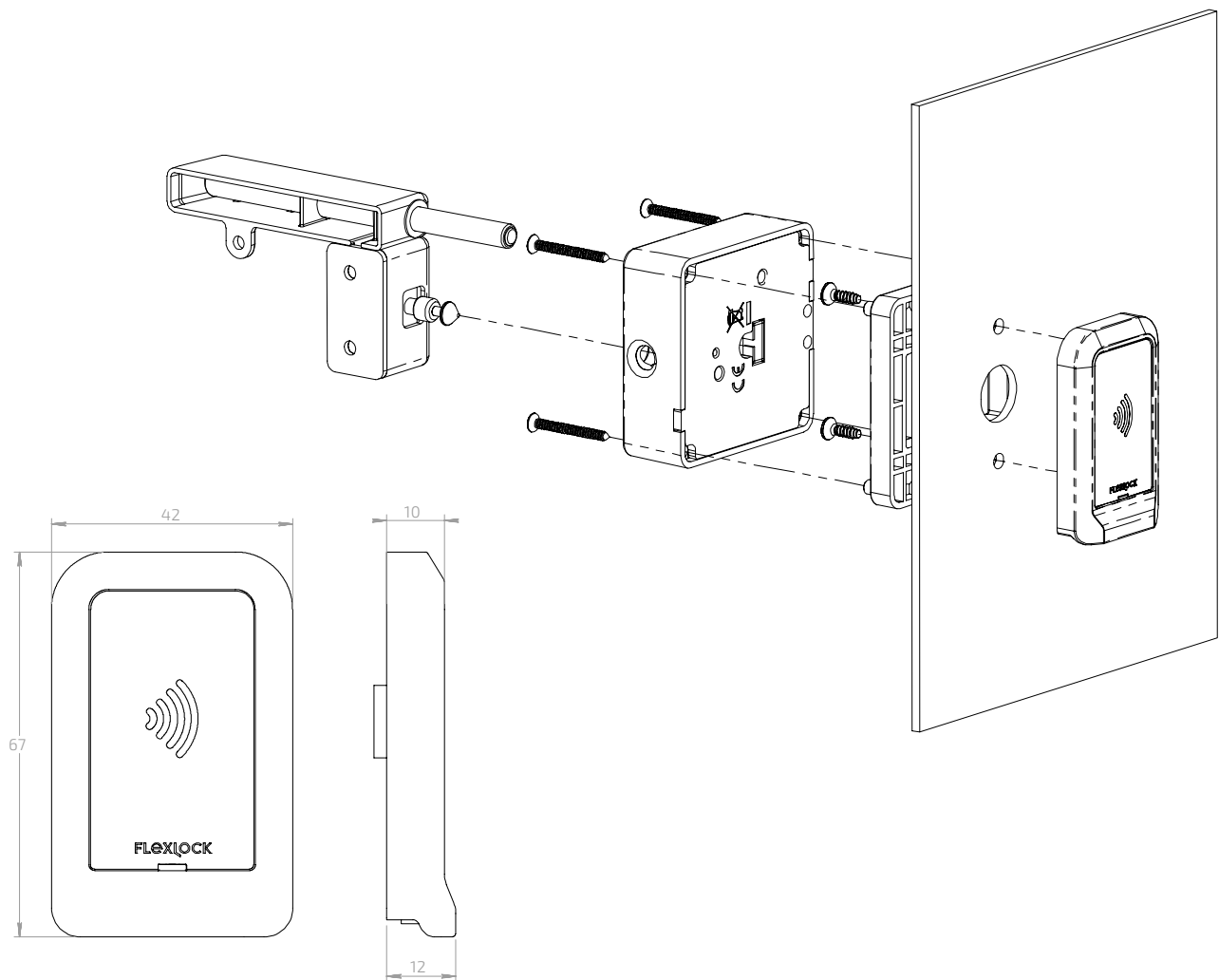

Size	67 x 67 x 23 mm
Weight	54 g (without battery)
Temperature, surrounding	+17° till +30° C
Humidity	20% to 75% relative humidity, non-condensing
Battery	For battery life and software to work according to specification requires a Flexlock battery which is provided by Swedstyle or your Flexlock dealer
HF emission	Max 20dBµA vid 10 m
IP-code	IP 20
Number of users	Max 200 st
Battery lifespan	2 to 3 years
RFID	13,56 MHz: ISO/IEC 14443 A & B, ISO/IEC 180092, ISO/IEC 15693
Compatible with	13,56 MHz: Mifare Classic 1k, Mifare Classic 4k, Mifare DESFire EV1, EV2 & EV3, ISO 14443A, Legic Advant 15693, Mifare Plus, Mini, Ultra Light HID iClass 2k, iClass 4k, iClass SE 2k, 32k
Reading distance	< 25 mm with Swedstyle-cards, other cards or tags may have shorter and varied reading distance
Lock standard	SS-EN 16014:2011, Designed for DIN 4547 Class B
Electrical safety	IEC/EN/UL 62368, CSA 22.2
EMC and EMR radio test	ETSI 300 330-1/-2 och 301 489-1/-3, FCC Part 15B, ICES-003
Bluetooth low energy	The Card+ mobile app requires support for BLE minimum 5.0
Mobile phone requirements	iPhone 8, Android 8.0 or later version

Flexlock is CE marked and meets the requirements, see separate CE declaration.

More info at www.flexlock.se

Flexlock is a product developed and marketed by Swedstyle.

 SWEDSTYLE

Swedstyle AB
Box 171
SE-567 24 Vaggeryd, Sweden
info@swedstyle.se
+46 393-363 60
www.swedstyle.com